

MALI-008636-000000

Ka-Band Waveguide Limiter
34.2 - 35.3 GHz

2010 Data Sheet v1

COBHAM

The most important thing we build is trust

Description

This Ka-Band waveguide limiter provides excellent protection from unwanted signals. It has low insertion loss to optimise system performance.

Features

- High Reliability
- Ka-Band
- Low insertion loss
- WG22 / WR28 Interface
- European Manufacture.

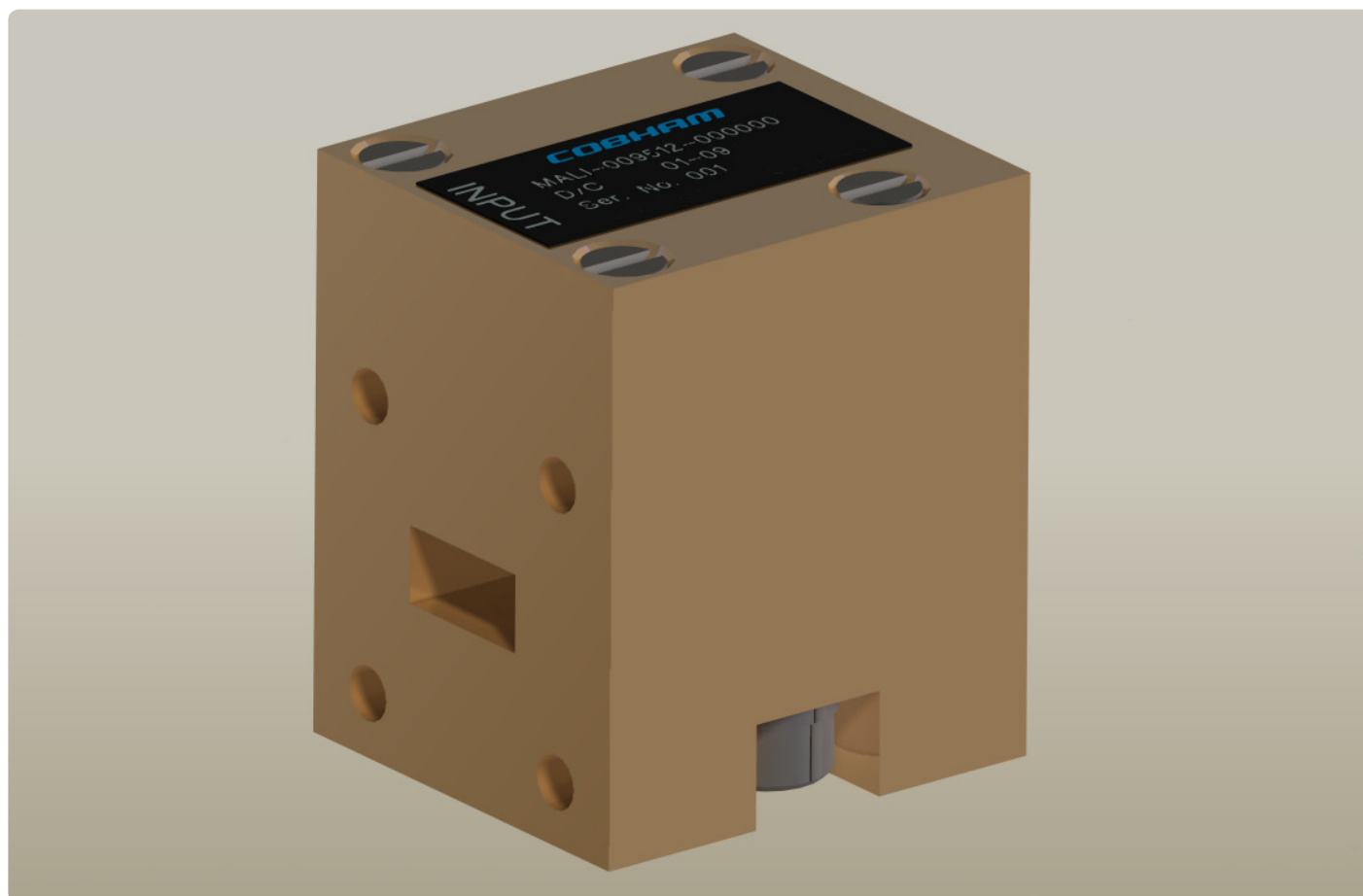

MALI-008636-000000



Ka-Band Waveguide Limiter
34.2 - 35.3 GHz
2010 Data Sheet v1

RF Performance

Parameter	Value			Units
	Min.	typ.	Max.	
Frequency Band	34.2		35.3	GHz
Insertion Loss (Input power \leq -10 dBm)		0.8	1.5	dB
Input / Output Return Loss (Input power \leq -10 dBm) Input / Output terminated in characteristic impedance.		1.22:1	1.4:1	Ratio
Input Power (CW or Pulsed)			4	W
Flat Leakage		13	17	dBm
Spike Leakage (RF rise time \geq 5 ns)		19	23	dBm
Recovery time, Normal Operating (To within 1 dB of Insertion Loss)		150	250	ns

(Applies over the frequency range, output and input characteristic impedance of stated waveguide. Unless otherwise stated limits & conditions are indicated values.)

Environmental	
Operating Temperature	-40°C to +85°C
Storage Temperature	-55°C to +100°C
RF Connections	
Input / Output flanges compatible with UG/599 plain flange	WG22, WR28

Typical Results

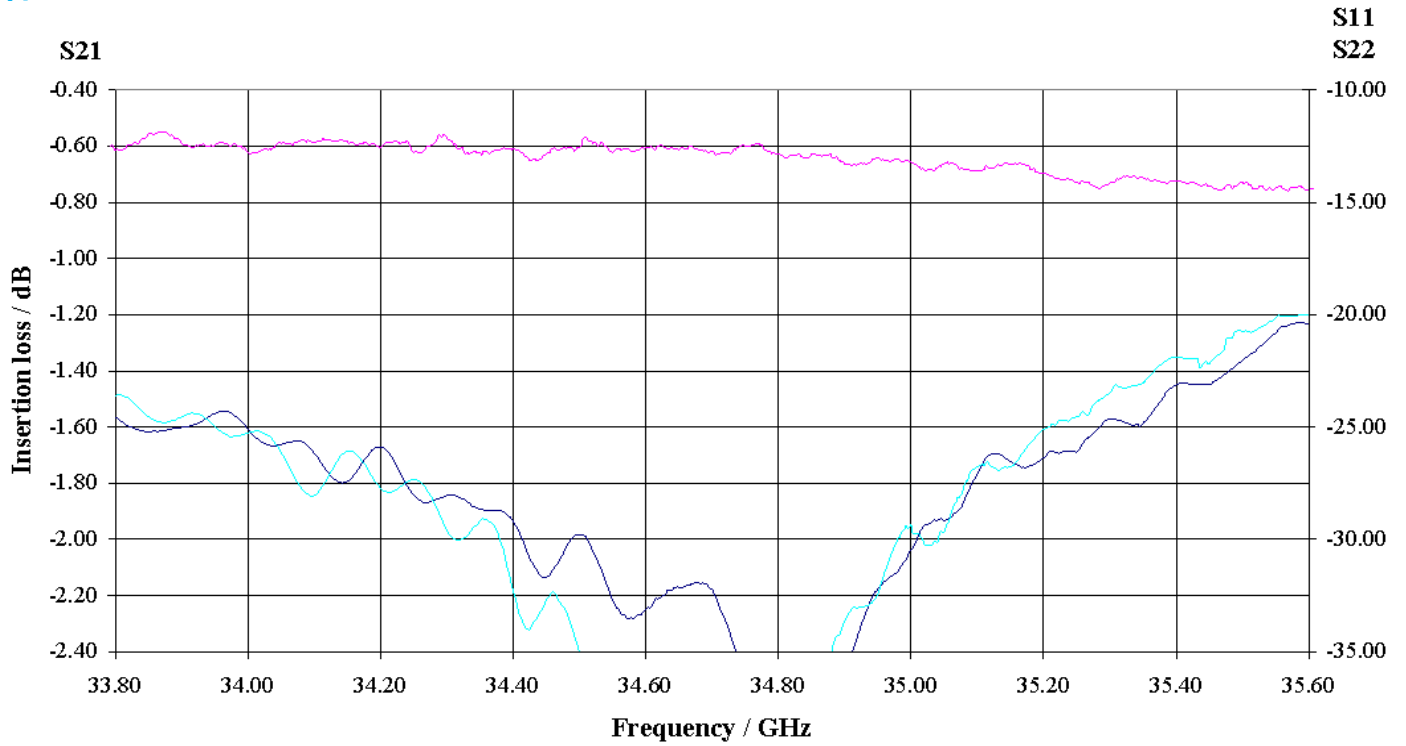

Mechanical Outline

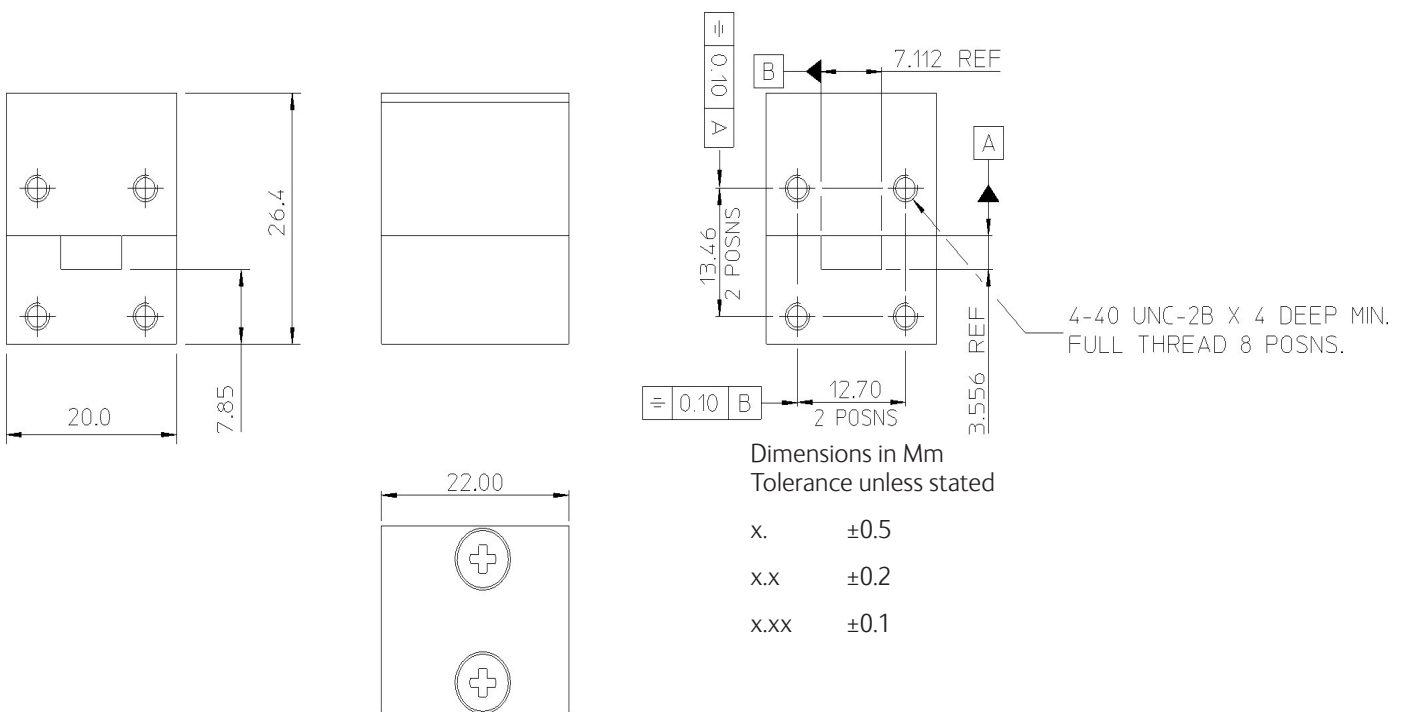
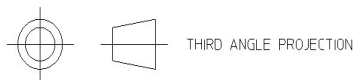



For further information please contact:

Cobham Sensor Systems

Featherstone Road
Wolverton Mill
Milton Keynes, MK12 5EW
England

Tel: +44 (0) 1908 574200

Fax: +44 (0) 1908 574300

E-mail - cobham.mal@cobham.com